



DAWSON JONES

.....

STORE FIXTURES

FULL VIEW WALLCASE ASSEMBLY INSTRUCTIONS



2960 Amwiler Rd.
Atlanta, Ga 30360
dawsonjones.com
(800) 418-1954
(770) 458-7234

NOTE: It is recommended that two persons assemble this unit.

PARTS LISTING



TOP GUIDE (x4)



GLASS GLAZING (6)

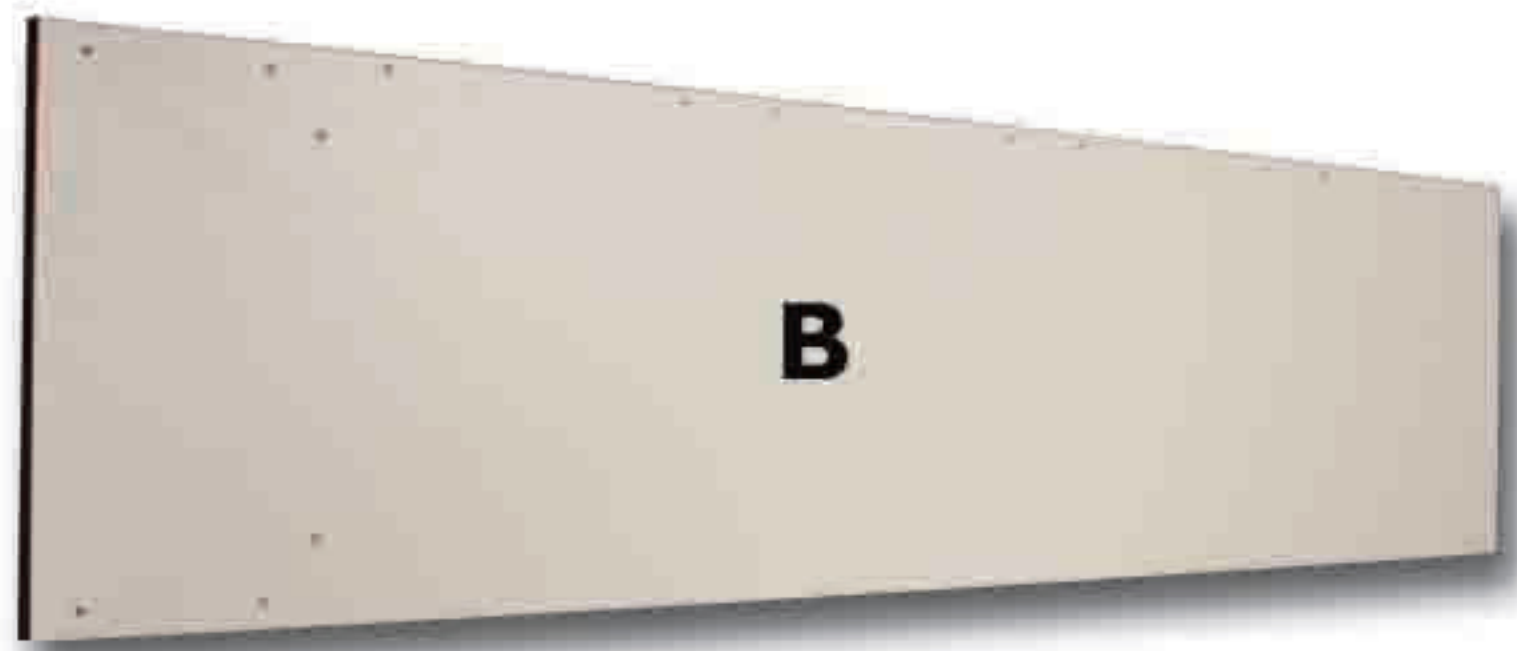

RIGHT SIDE PANEL (x1)



#6x12 PAN SCREW (x10)



BT12C (x10)

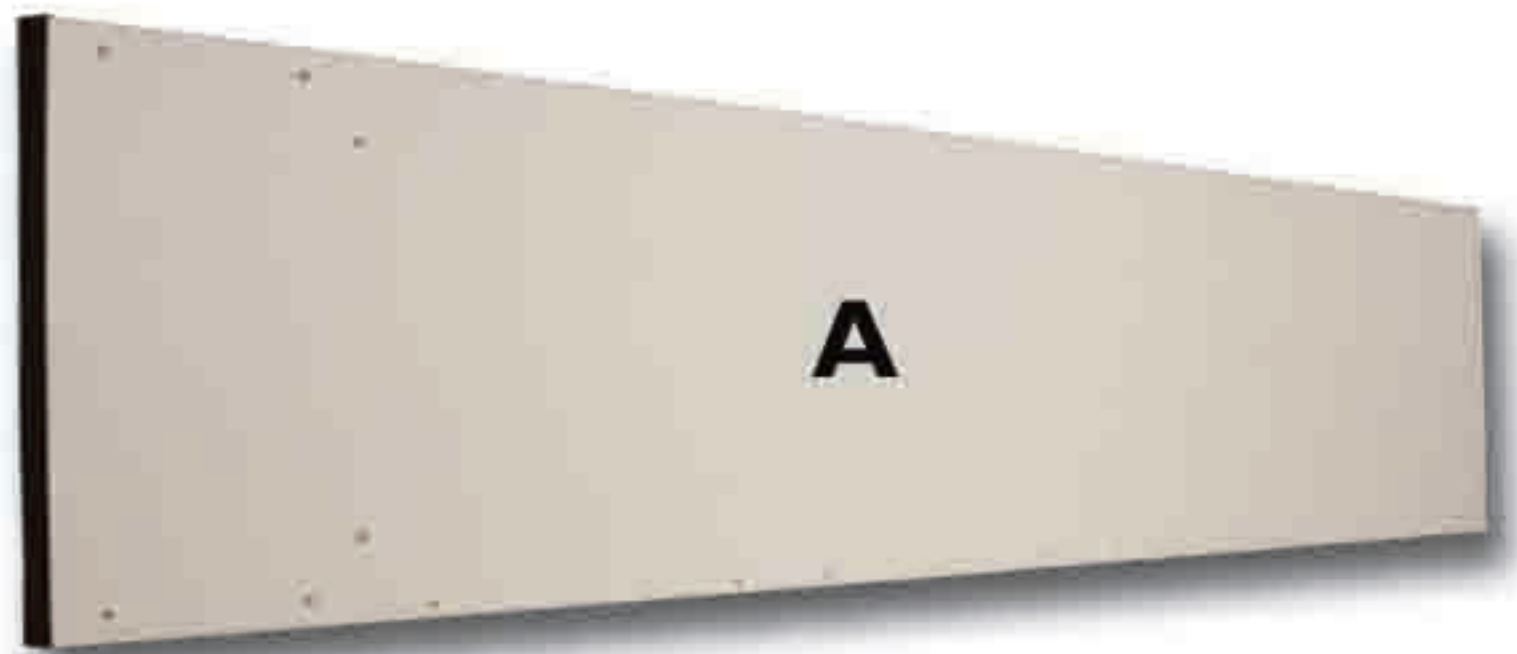

LEFT SIDE PANEL (x1)



#6x114 PHILLIPS SCREW (x12)



NE09034-4 (x2)



SSI067 (x2)



TOP PANEL (x1)



WOOD SCREW (x2)



HWI8 (x1)



HWI17-4 (x1)



HWI16 (x1)



TOE KICK (x2)



#10 SCREW CAP (x16)



HWI16-S (x2)

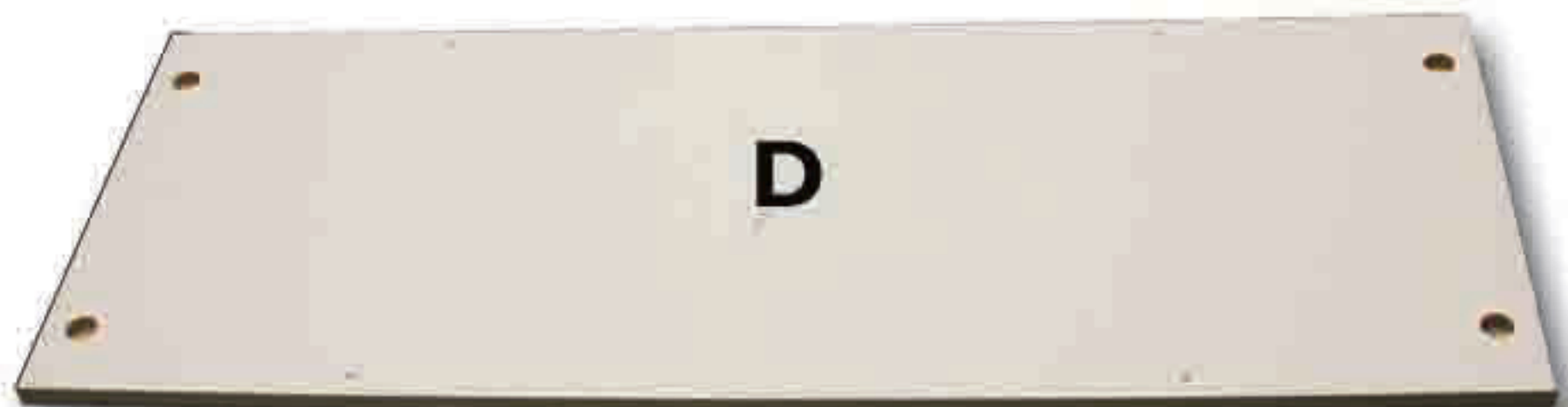

BOTTOM PANEL (x1)



GLIDE (x4)



LI244 (x5)



BACK TOP (x1)



#10 CAM LOCK (x36)

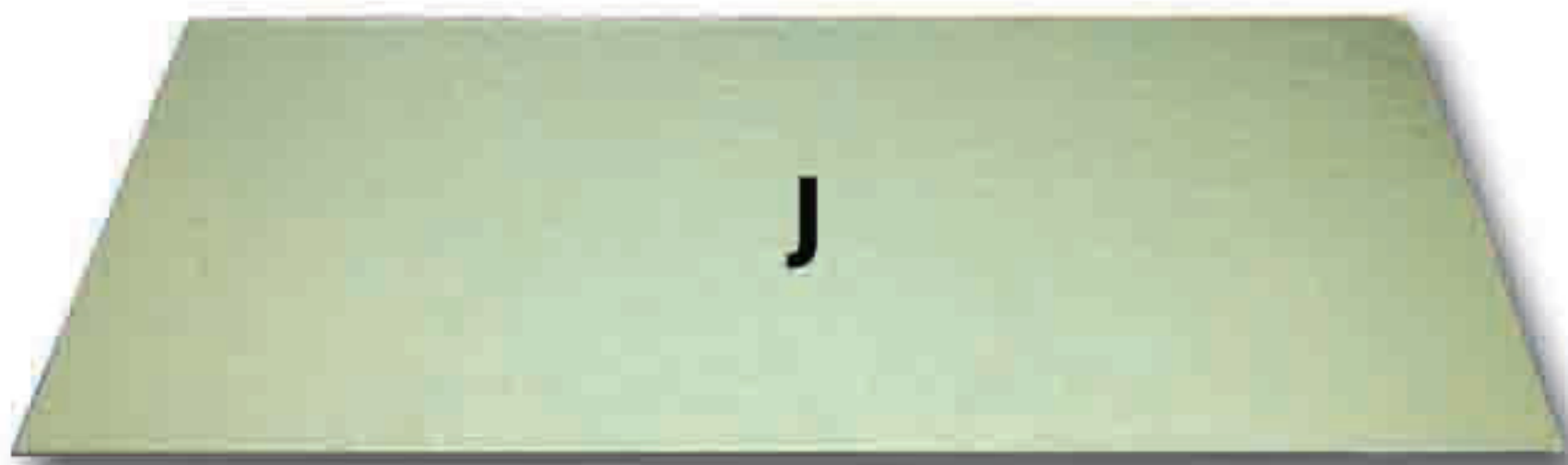

L2360 (x2)



BACK PANEL (x3)



DOWEL PIN (x6)



BOLT (x36)

TOOLS NEEDED



TOP FRONT (x1)

I.

BASE ASSEMBLE

BOTTOM PANEL (x1)
TOE KICK (x2)
#10 CAM LOCK (x16)
BOLT (x4)
GLIDE (x4)

1. Connect toe kick to bottom panel using bolts.
2. Insert and tighten #10 cam locks.
3. Attach glides on the toe kick.



2.

BACK PANEL ASSEMBLE

LEFT SIDE PANEL (x1)
TOP BACK PANEL (x1)
BACK PANEL (x3)
#10 CAM LOCK (x16)
BOLT (x18)
DOWEL PIN (x6)

1. Attach assembled base to left side panel using bolts.
2. Tighten #10 cam locks.
3. Attach back panel to left side panel using bolts.
4. Attach other back panel with left side panel and attached back panel using bolts and dowel pins.
5. Attach top back panel to left side panel and attached back panel using bolts and dowel pins.



3. TOP PANEL AND FRONT ASSEMBLE

TOP PANEL (x1)
FRONT PANEL (x1)
#10 CAM LOCK (x8)
#6X1 1/4 PHILLIPS SCREW (x2)
WOOD SCREW (x2)

1. Connect top front panel to top panel using #6x1 1/4 phillips screws.
2. Attach assembled top panel with left side panel using bolts; with top back panel using wood screw.
3. Tighten all #10 cam locks on left side panel and front panel.



4. RIGHT SIDE PANEL ASSEMBLE

RIGHT SIDE PANEL (x1)
BOLT (x18)
#10 SCREW CAP (x16)

1. Attach right side panel to case using bolts.
2. Tighten #10 cam locks.
3. Put case stand on floor.
4. Install #10 screw cap.



5.

STANDARD ASSEMBLE

SSI067 (x2)

#6x1 1/4 PHILLIPS SCREW (x10)

1. Attach SSI067 to case on proper position using #6X1 1/4 phillips screws.



6.

DOOR FRAME ASSEMBLE

HW116-4 (x1)

HW116-S (x2)

HW18-4 (x1)

HW117-4 (x1)

#6x12 PAN SCREWS (x10)

1. Attach HW116-4 to top front panel using #6x12 pan screws.

2. Attach HW116-S to right side panel using #6x12 pan screws.

3. Attach HW116-S to left side panel using #6x12 pan screws.

4. Attach HW117-4 to bottom panel using #6x12 pan screws.

5. Snap HW18-4 into HW117-4.

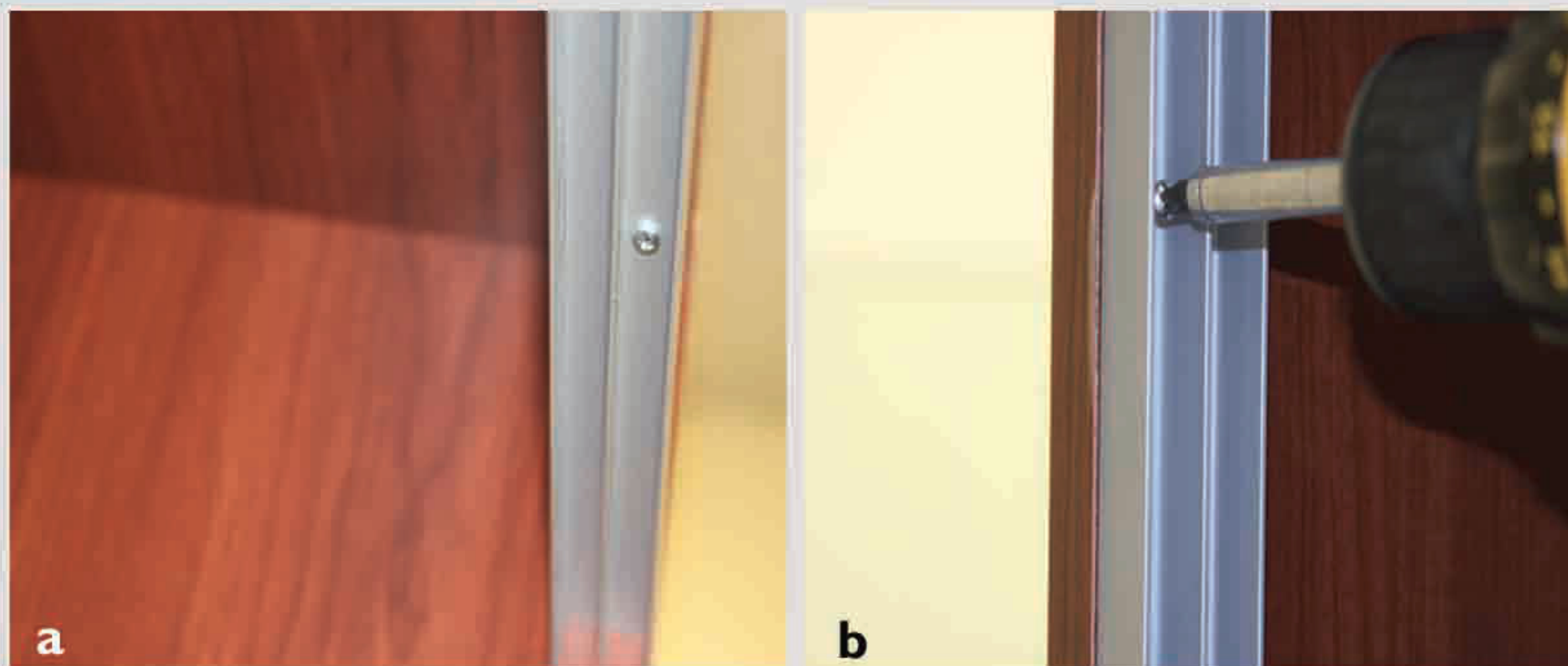

b

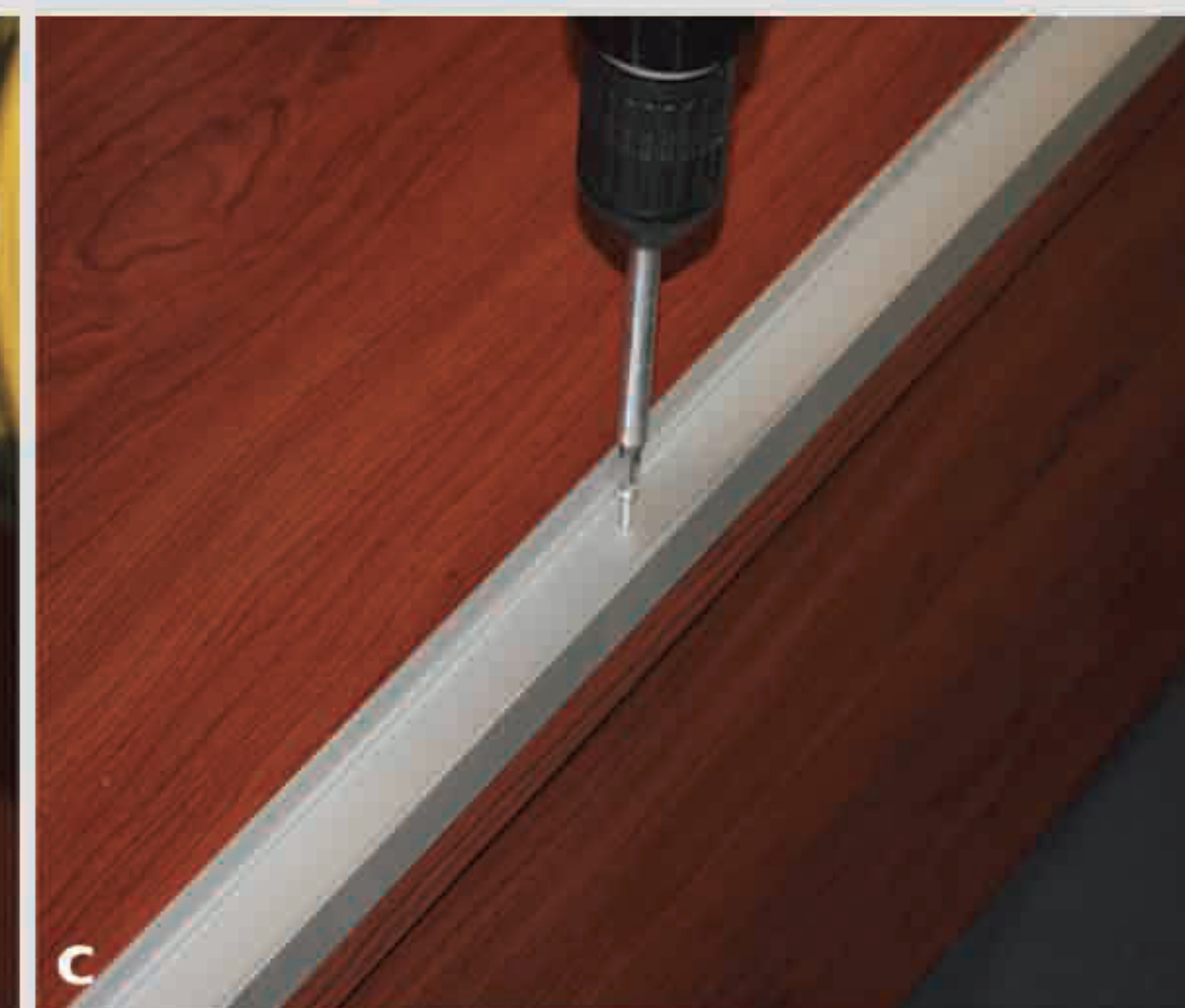
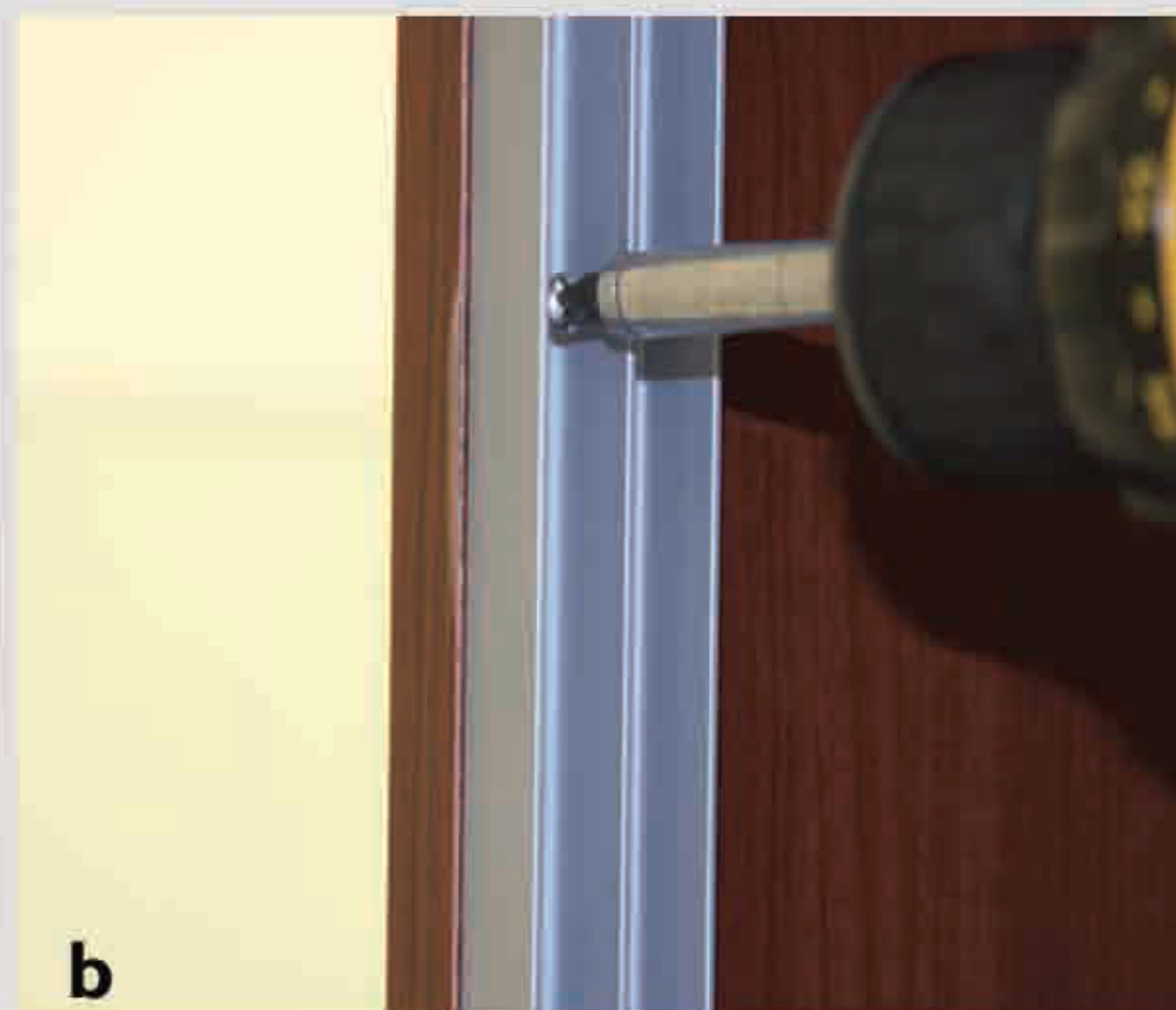

7.

BRACKET AND GLASS SHELF ASSEMBLE

BT12C (x10)
GLASS SHELF (x5)

1. Attach BT12C to SS1067 with proper height.
2. Place glass shelf sit on brackets.



8.

GLASS DOOR ASSEMBLE

GLASS DOOR (x2)
GLAZING CHANNEL (x6)
NE09034-4 (x2)
TOP GUIDE (x4)

1. Put 3 pcs of glazing channel on glass door.
2. Install NE09034-4 with glass door.
3. Put 2 pcs of top guide on the top of glass door.
4. Insert glass door into case.
5. Repeat 1~4 to install other glass door.

