

**3 TIER TABLE  
RETANGULAR SHAPE  
ASSEMBLY INSTRUCTIONS**



**DAWSON JONES  
STORE FIXTURES**



**BOLT  
(x44)**



**GLIDE  
(x4)**



**#10 CAM LOCK  
(x44)**



**#10 SCREW CAP  
(x8)**

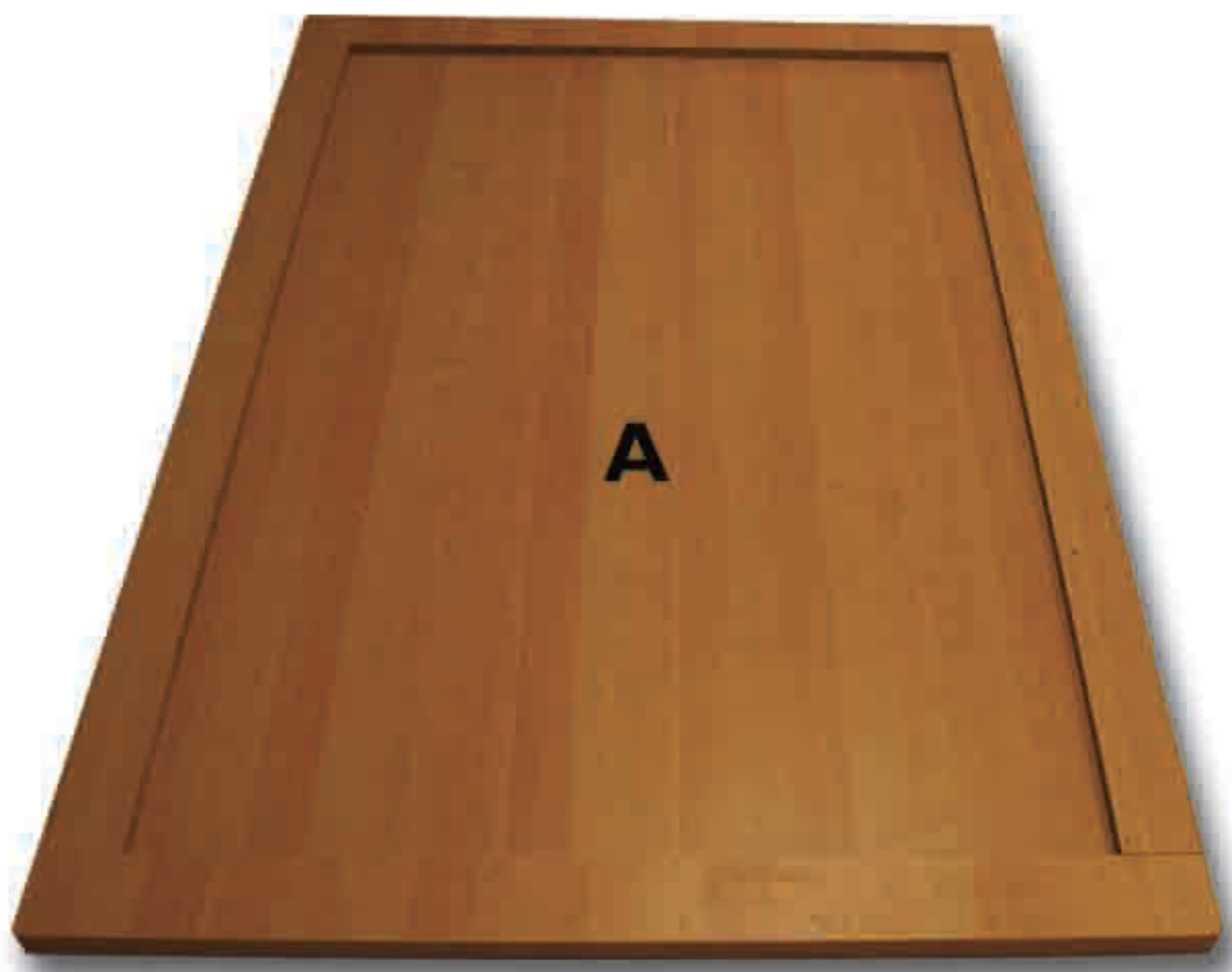

**BOTTOM TABLE (x1)**

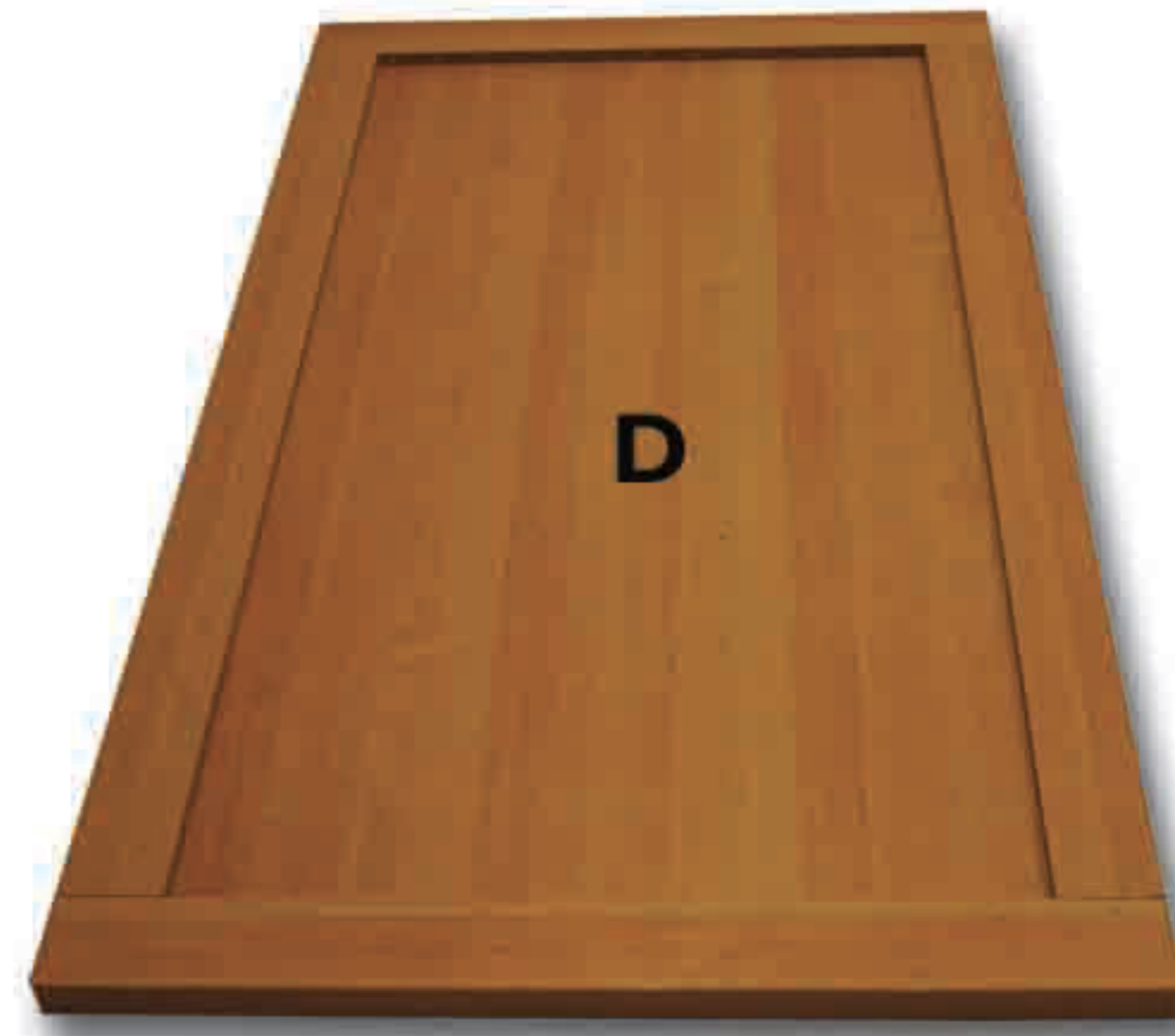

**MIDDLE TABLE (x1)**

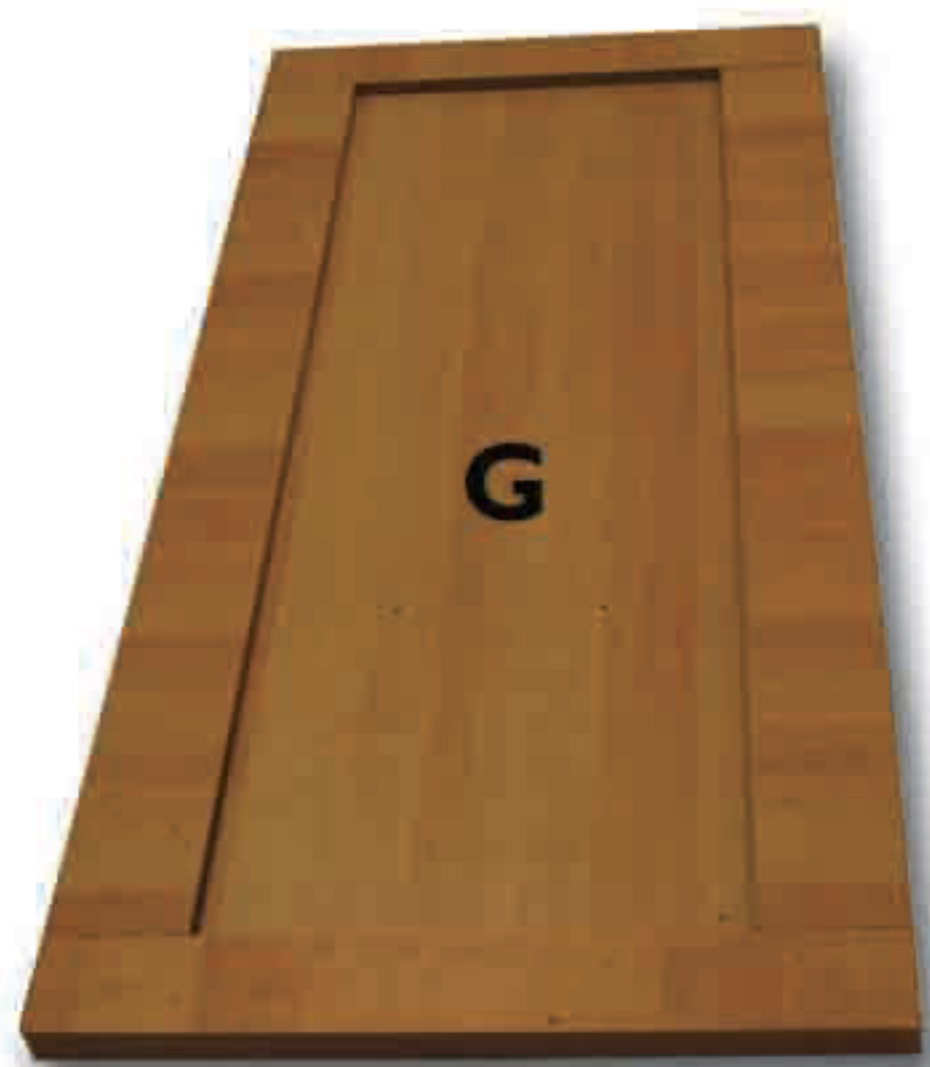

**TOP TABLE (x1)**



**TOP STAND PANEL (x2)**

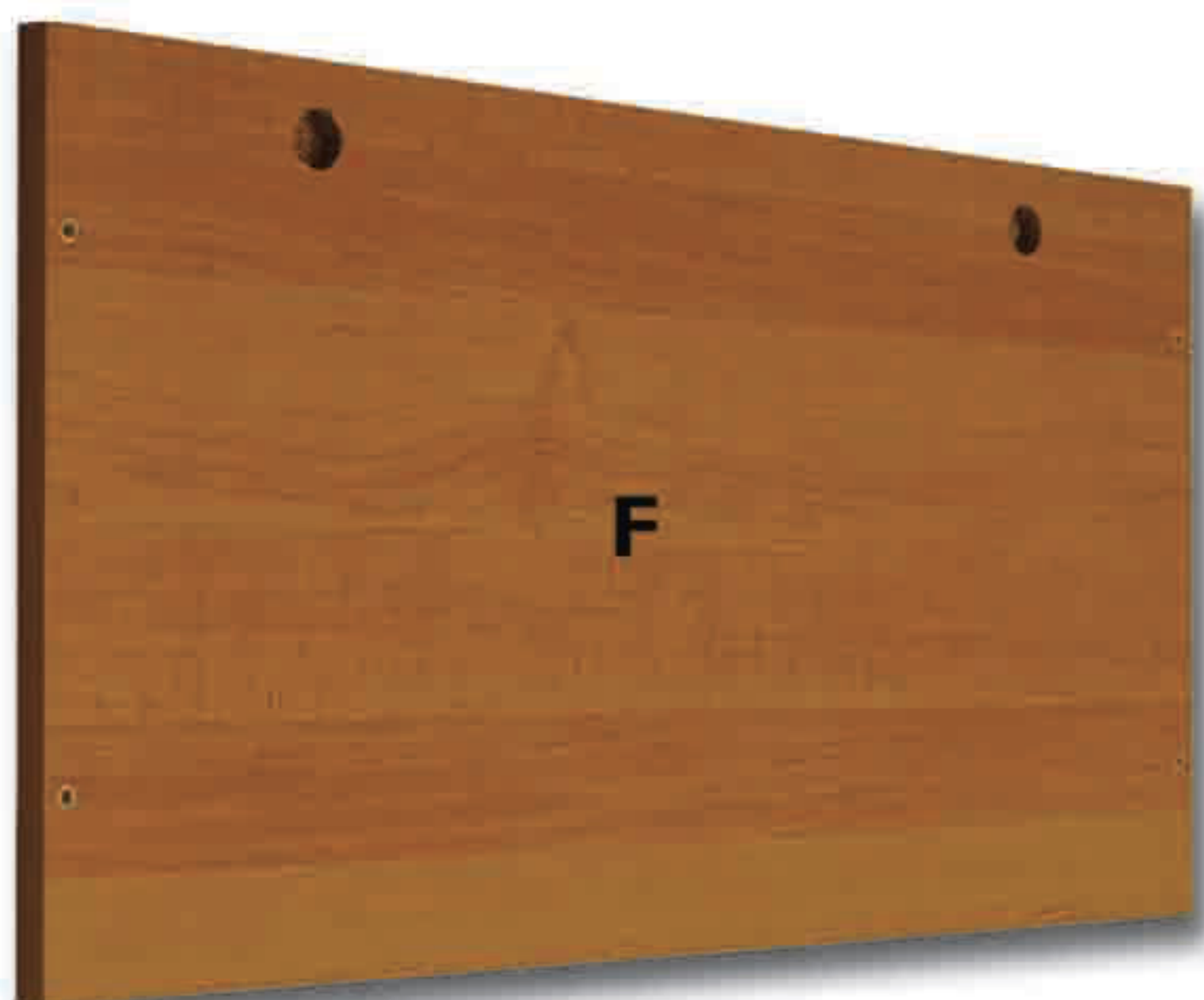

**MIDDLE STAND PANEL (x2)**

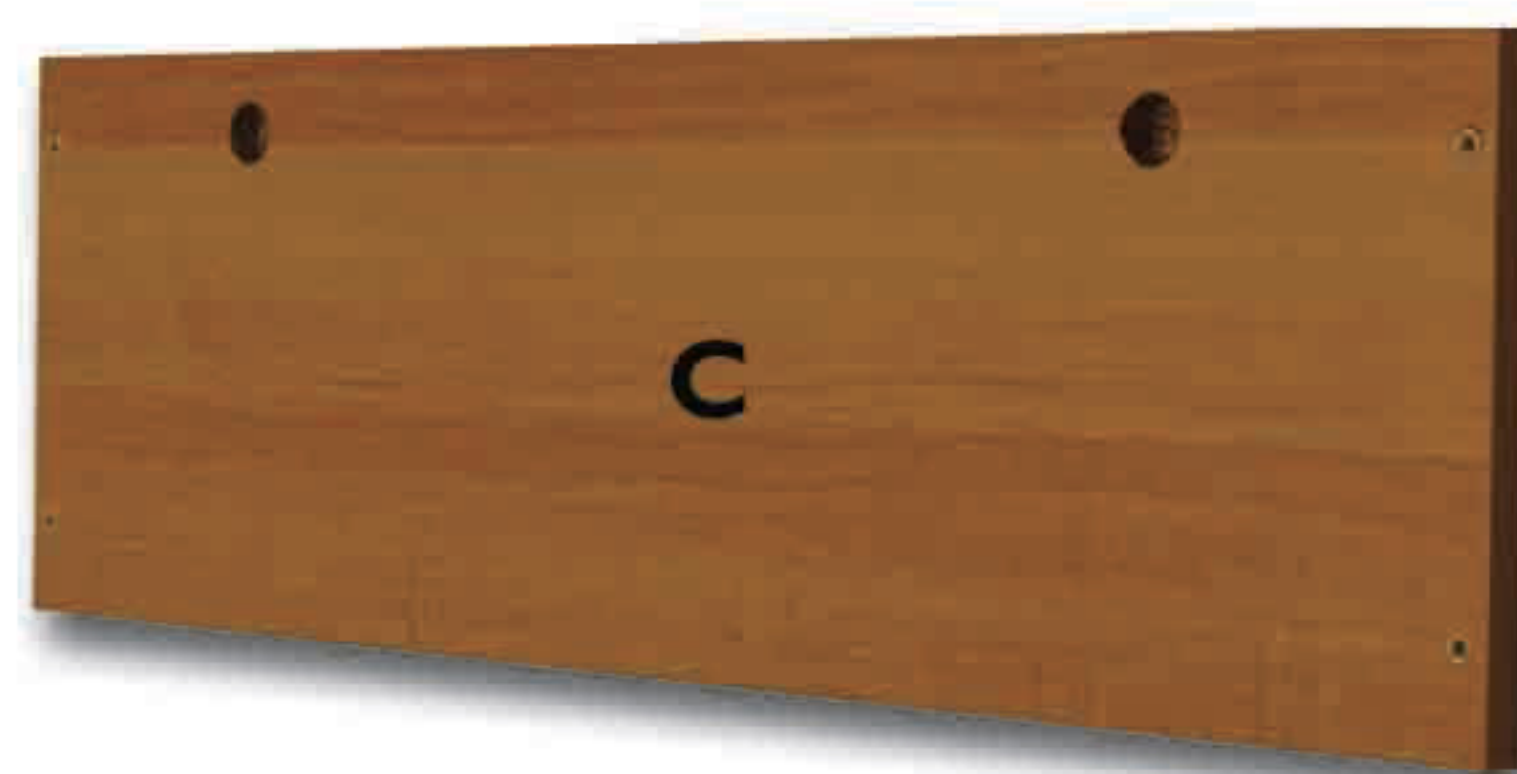

**TOE KICK (x2)**



**TOP STAND SIDE  
PANEL (x2)**



**MIDDLE STAND SIDE  
PANEL (x2)**

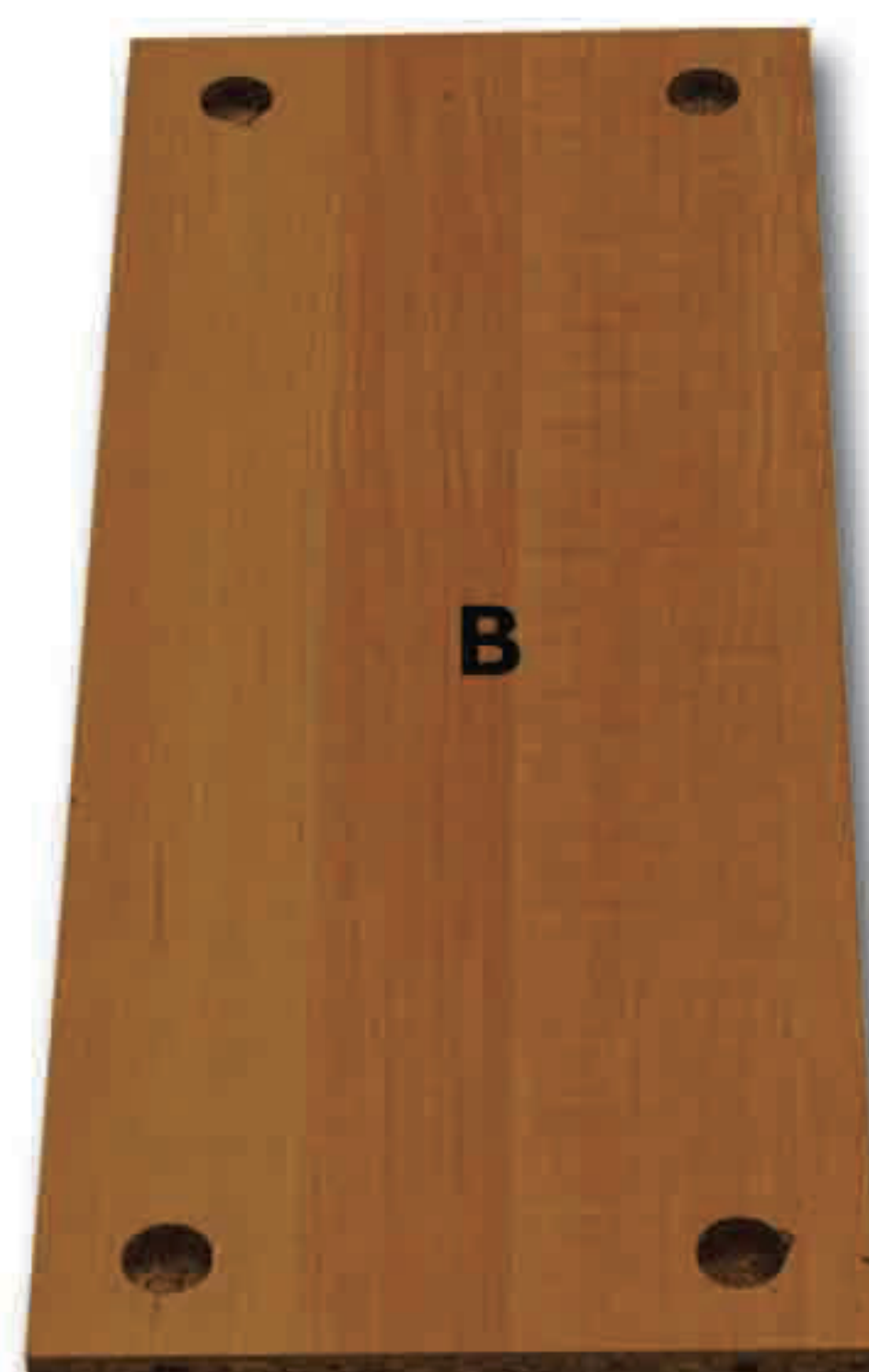

**SIDE TOE KICK (x2)**



2960 Amwiler Rd.  
Atlanta, Ga 30360  
dawsonjones.com  
(800) 418-1954  
(770) 458-7234

**TOOLS NEEDED**



*NOTE: It is recommended that two persons assemble this unit.*

1.

### **BOTTOM TABLE ASSEMBLE**

BOTTOM TABLE (x1)  
TOE KICK (x2)  
SIDE TOE KICK (x2)  
#10 CAM LOCK (x12)  
BOLT (x12)  
GLIDE (x4)

1. Connect toe kick to side toe kick using bolts.
2. Insert and tighten #10 cam locks.
3. Repeat 1 & 2 connect other toe kick to side toe kicks.
4. Attach glides on the toe kick.
5. Connect toe kicks to bottom table using bolts.
6. Insert and tighten #10 cam locks.
7. Sit bottom table on floor.

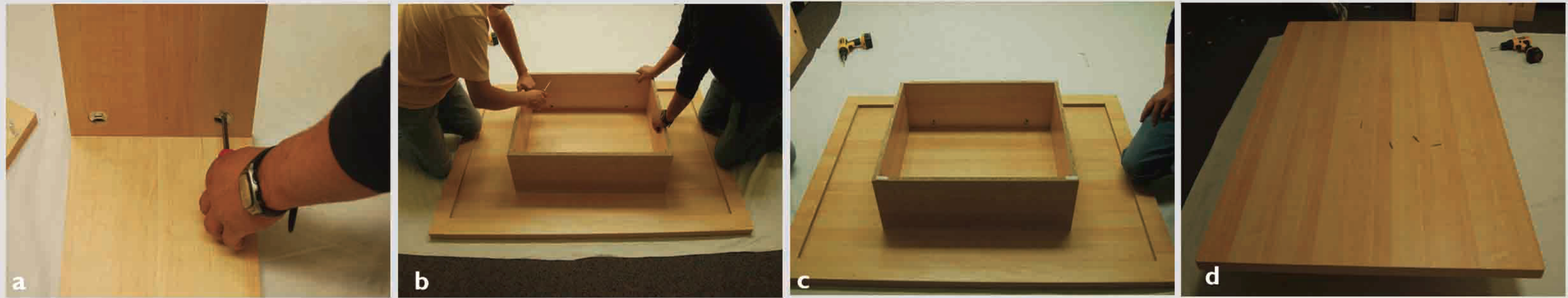

2.

### **MIDDLE TABLE ASSEMBLE**

MIDDLE TABLE (x1)  
MIDDLE STAND PANEL (x2)  
MIDDLE STAND SIDE PANEL (x2)  
#10 CAM LOCK (x16)  
BOLT (x16)  
#10 SCREW CAP (x4)

1. Connect middle stand panel to middle stand side panel using bolts.
2. Insert and tighten #10 cam locks.
3. Repeat 1 & 2 connect other middle stand panel to middle stand side panels.
4. Connect middle stand to bottom table using bolts.
5. Insert and tighten #10 cam locks.
6. Connect middle table to middle stand using bolts.
7. Insert and tighten #10 cam locks.
8. Install #10 screw caps.

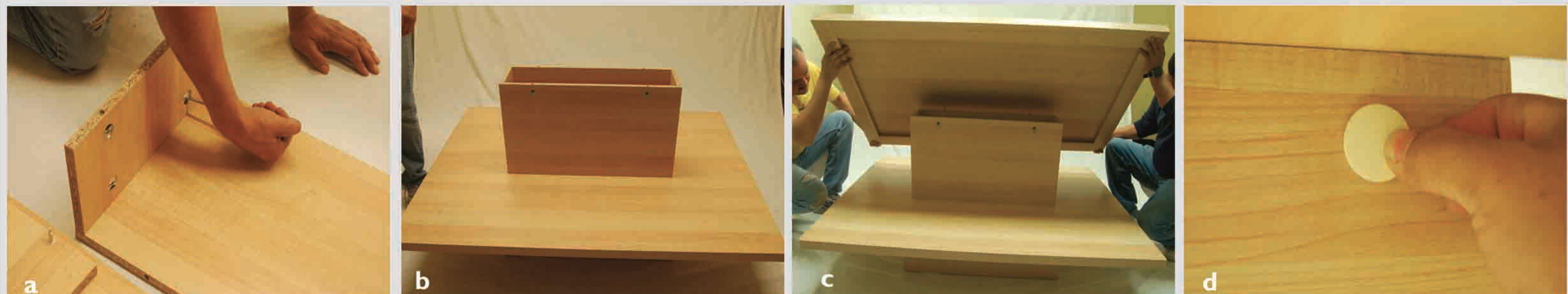

3.

### TOP TABLE ASSEMBLE

TOP TABLE (x1)  
TOP STAND PANEL (x2)  
TOP STAND SIDE PANEL (x2)  
#10 CAM LOCK (x16)  
BOLT (x16)  
#10 SCREW CAP (x4)

1. Connect top stand panel to top stand side panel using bolts.
2. Insert and tighten #10 cam locks.
3. Repeat 1 & 2 connect other top stand panel to top stand side panels.
4. Connect top stand to middle table using bolts.
5. Insert and tighten #10 cam locks.
6. Connect top table to top stand using bolts.
7. Insert and tighten #10 cam locks.
8. Install #10 screw caps.

